

R10

R9W6

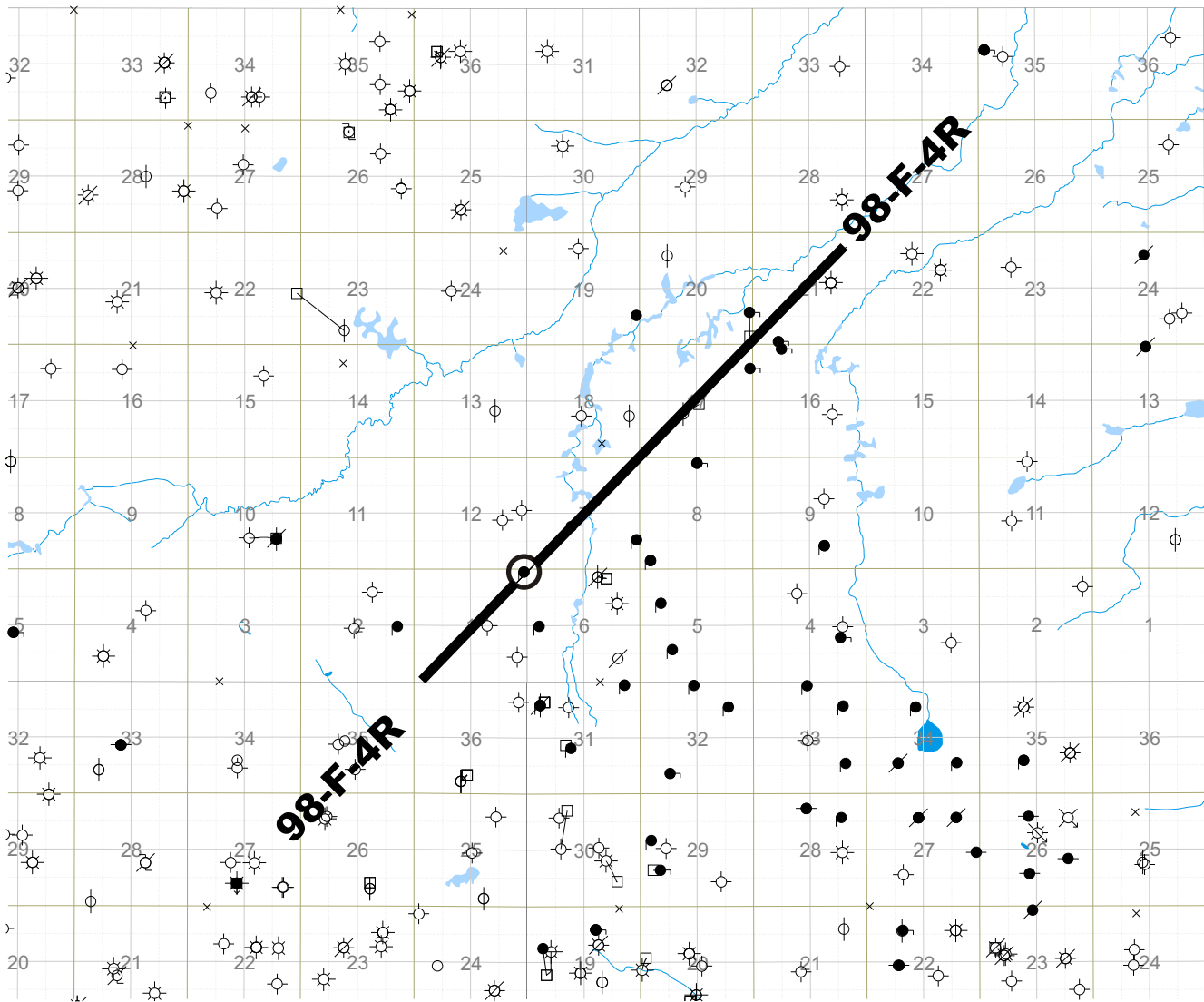

T80

T79

— IEXCO data available for licensing

SEISMIC LINE

98-F-4R 8.730KM

FOLD: 3000%

CHANNELS: 360



**INTERNATIONAL
EXPLORATION CONSULTANTS
(CANADA) INC.**
2850, 801-6 th Ave S.W. Calgary, Alberta T2P 4A3
Tel (403) 233-7922 Fax (403) 237-6563

FARMINGTON

ALBERTA